

**New !!**

**Ring Pump®**

# RP-H II Series For "Fixed Flow Rate" Pump System



## Features

- High flow rate type
- Pump head is replaceable and the docking of pump head can be done in a single action. No screw bolt needed.
- Pump head can be sterilized.  
\* By autoclave : 121°C 25 minutes  
Gamma rays : 25 kGy etc.
- You can select tubing from 4 kinds of materials.

## Main specifications

|                        |                             |
|------------------------|-----------------------------|
| Flow rate              | Max. 70mL / 1.0mL - Step    |
| Tubing                 | Silicone/Pharmed/TM-15/SWFT |
| Motor/Power source     | DC 24V                      |
| Material of main parts | Base, Case, Cover : PBT     |
| Weight (for reference) | Approx. 360g                |

## Examples of application

Analytical instruments, medical devices, cell culturing experiments and many other usage where micro-fluidic control is needed.

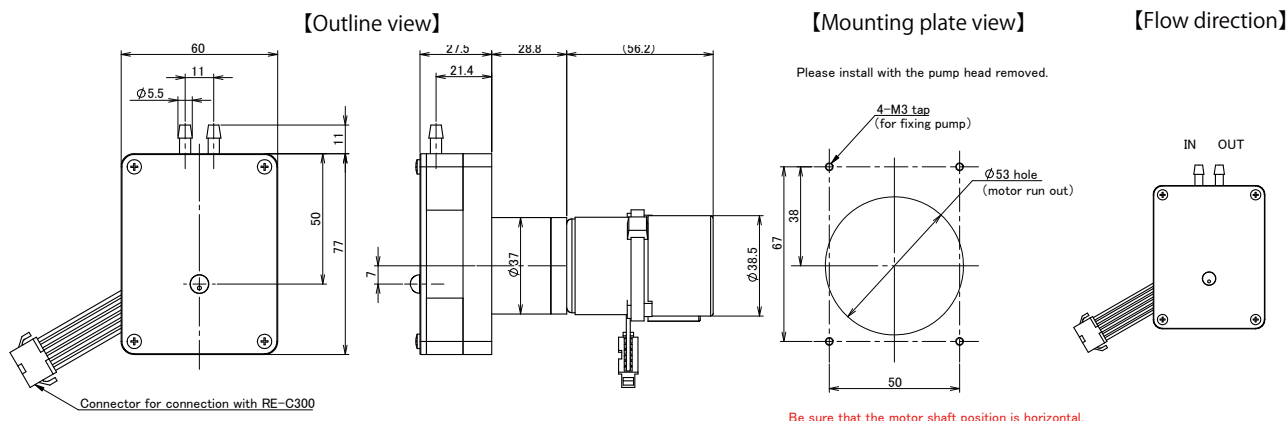

## Model Lineup

| Model Lineup           | Voltage (DC/V) | Flow rate (Max. mL) | Tubing       |              | Product name of Pump system |
|------------------------|----------------|---------------------|--------------|--------------|-----------------------------|
|                        |                |                     | Type         | ID x OD (mm) |                             |
| RP-H II 04S-70A-DC24VE | 24             | 70                  | Silicone (S) | 4 x 6        | RE-C300-H II 04S            |
| RP-H II 04F-70A-DC24VE | 24             | 70                  | PharMed (F)  | 4 x 6        | RE-C300-H II 04F            |
| RP-H II 04W-70A-DC24VE | 24             | 70                  | TM-15 (W)    | 4 x 6        | RE-C300-H II 04W            |
| RP-H II 04C-70A-DC24VE | 24             | 70                  | SWFT (C)     | 3.9 x 5.8    | RE-C300-H II 04C            |

## Motor controller RE-C300



## Display panel of PC software

